

## PRODUCT DATASHEET

# DAMPY B 219/500 - DAMPY B 219/700

### Semi-automatic gas bollard

Semi-automatic bollard with internal spring and mechanism release system by key. Designet and built with the same styling as the automatic models so that they can be combined in the same installations. Available in two dimensions.

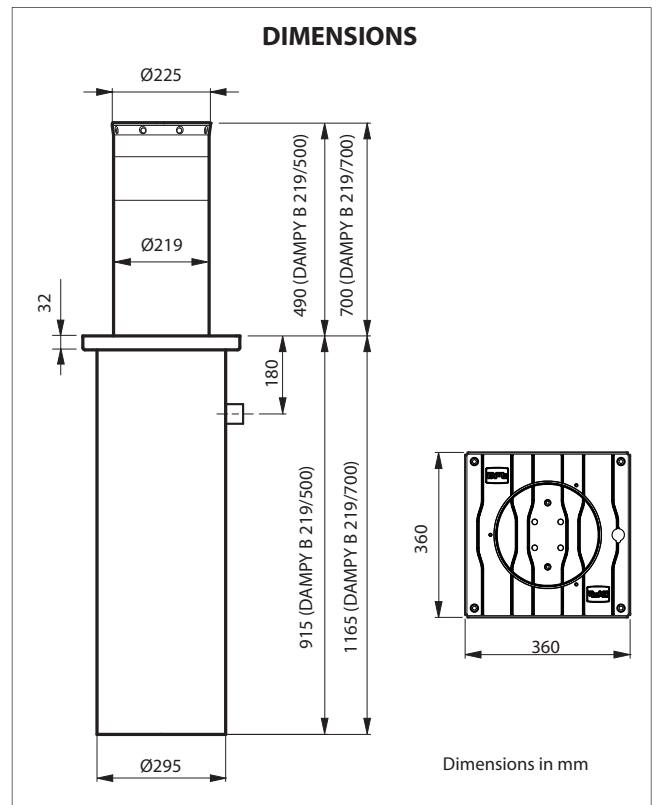

#### • Gas bollards

- Break-in resistance: **150 000 J**
- Rod steel, cathoporesis and coating; stainless steel (optional)
- Adhesive film-reflectORIZED band, customizable (optional)
- End stroke automatic locking system with assisted shaft rising
- Mechanism release system by standard triangular bit release key; also available in a security version with special bit (optional)
- Accessorisable with LED light cap

#### REFERENCE STANDARDS

2004/108/CEE; 93/68/CEE ( EN55014-1; EN55014-2 ) • Electromagnetic Compatibility  
2006/95/CEE; 93/68/CEE ( EN60335-1(2002) ) • Low voltage  
2006/42/CEE ( EN60204-1 ) • Machinery directive

TECHNICAL-ENVIRONMENTAL MAIN FEATURES	
<b>Driven rod out of the ground</b>	DAMPY B 219/500: Ø220 x h.490 mm (±3mm) x th.5 mm, steel Fe 360 (S 235 JR) * DAMPY B 219/700: Ø220 x h.700 mm (±3mm) x th.5 mm, steel Fe 360 (S 235 JR) *
<b>Buried structure</b>	DAMPY B 219/500: Ø295 x h.915 mm DAMPY B 219/700: Ø295 x h.1165 mm
<b>Foundation</b>	Concrete
<b>Excavation</b>	DAMPY B 219/500: ~1000 x 1000 x h.1200 mm DAMPY B 219/700: ~1000 x 1000 x h.1400 mm
<b>Break-in resistance</b>	150 000 J
<b>Allowable axial static load</b>	Bollard up max 3 000 N; bollard down max 150 000 N
<b>Driven rod treatment</b>	Cataphoresis and coating RAL7015 standard, other colour on request
<b>Passive visibility</b>	Reflective film **
<b>Flange</b>	Cast iron, cataphoresis black
<b>Top cover</b>	Cast iron, cataphoresis black
<b>Lifting</b>	By means of a gas spring
<b>Weight including packaging</b>	DAMPY B 219/500: ~60Kg DAMPY B 219/700: ~100Kg

\* option, AISI304 or AISI316

\*\* Customizable (optional)

ELECTRICAL FEATURES (optional)	
<b>Light power supply</b>	ALLU
<b>Power</b>	Light cable 24 Vac ±10%, 50-60 Hz (up to 80 bollards)
<b>Power consumption</b>	1 W for each bollard
<b>Signalling</b>	On the top with high intensity LEDs and buzzer (optional)

For system composition and installation refer to the regulations in force in the country where the system is being installed.

## ITEM SPECIFICATION

Semi-automatic gas bollard. Available in two sizes:

- Ø220 x h.490 x th.5 mm, steel Fe 360 (S 235 JR). Break-in resistance up to 150 000 J. End of travel automatic locking system with assisted shaft rising. Mechanism release system by standard triangular bit release key.

- Ø220 x h.700 x th.5 mm, steel Fe 360 (S 235 JR). Break-in resistance up to 150 000 J. End stroke automatic locking system with assisted shaft rising. Mechanism release system by standard triangular bit release key.

